

DISCHARGE VALVE ASSEMBLY AND SUCTION VALVE GUARD

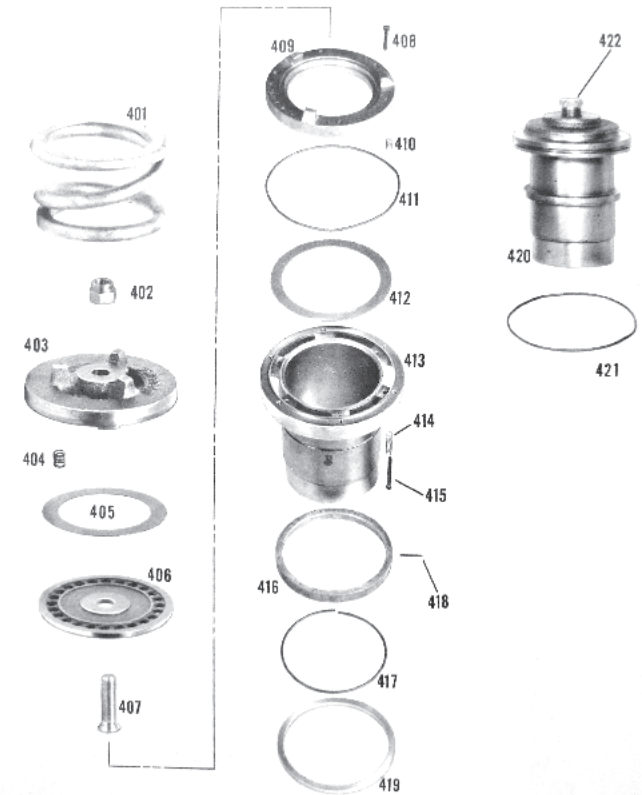

**MODELS
330 & 340 VMC**

**MODELS
320 VMC & 350ES**



ITEM	DESCRIPTION	VILTER PART NUMBERS			
		Model 320	Models 330 & 340 Serial #'s Below 10,000	Models 330 & 340 Serial #'s Above 10,000	Model 350ES
401	Spring Safety Head	33629A	-	-	33629A
402-407	Discharge Valve Guard and Seat Assembly	-	A33959A	A33959A	-
	Single Stage	A33660B	-	-	A336608
	Booster	A33660C	-	-	A336600
402	Nut, Lock	1776C	1776A	1776A	1776A
403	Guard, Discharge Valve	-	33697A	33697A	-
	Single Stage	N33640A	-	-	33640A
	Booster	33881A	-	-	45346A
404	Spring, Discharge Valve	-	33643A	33643A	33643A
	Single Stage	33643A	-	-	-
	Booster	33803A	-	-	-
405	Plate, Discharge Valve	33622A	33622A	33622A	33622A
406	Seat, Inner Valve	-	33690A	33690A	33641B
	60° Hole Serial #0-499	33641A+	-	-	-
	82° Hole Serial # 500- Present	33641B	-	-	-
407	Screw, Hex Socket Flat Head Cap	-	1774A	1774A	1527A
	60° Hole Serial #0-499	T31062C	-	-	-
	82° Hole Serial # 500- Present	1527A	-	-	-
408-417	Suction Guard and Liner Assembly	-	A34413A	A34546A	-
	Single Stage or High Suction	A33661A	-	-	A35319EH
	Booster or Low Suction	A33661D	-	-	A35319EL
	(for cylinders with unloading)	-	-	-	-
408-417	Suction Guard and Liner Assembly	-	A34413B	A34546B	-
	Single Stage or High Suction	A33661B	-	-	A35319DH
	Booster or Low Suction	A33661E	-	-	A35319DL
	(for cylinders without unloading)	-	-	-	-
408-413,	Suction Guard and Liner Assembly	-	A34413C	A34546C	-
	Single Stage Or High Suction	A33661C	-	-	A35319FH
	Booster or Low Suction	A33661F	-	-	A35319FL
416-418	(for cylinder adjacent to single cylinder unloading)	-	-	-	-

ITEM	DESCRIPTION	VILTER PART NUMBERS			
		Model 320	Models 330 & 340 Serial #'s Below 10,000	Models 330 & 340 Serial #'s Above 10,000	Model 350ES
408	Screw Hex Socket Head	13160P	13160P	13160P	13160P
408A	Washer	-	-	-	2946A
409	Guard Suction Valve	-	33689A	35041P	-
	Single Stage or High Pressure	N33639A	-	-	34949A
	Booster or Low Pressure	33879A	-	-	33639A
410	Spring Suction Valve	-	33644A	33644A	-
	Single Stage or High Pressure	33644A	-	-	35381A
	Booster or Low Suction	33803A	-	-	33644A
411	Seal "O" Ring	33331D	33331D	33331D	33331D
412	Plate Suction	33621A	33698A	33621A	33621A
411, 413	Cylinder Liner Assembly	Kit 1006	Kit 1036	Kit 1006	Kit 290
thru 417	(for cylinders with unloading)	-	-	-	-
411&413	Cylinder Liner Assembly	Kit 1007	Kit 1037	Kit 1007	Kit 291
	(for cylinders without unloading)	-	-	-	-
411, 413	Cylinder Liner Assembly	Kit 1008	Kit 1038	Kit 108	Kit 292
416, 418	(for cylinder adjacent to single cylinder unloading)	-	-	-	-
413	Liner Cylinder	N32640A	32684A	N32640A	34831A
414	Spring Unloader Ring	33428A	33428A	33428A	33428A
415	Pin Lift	33631A	33631A	33631A	33631A
416	Ring Lift	33632A	33632A	33632A	35318A
	(for cylinders with unloading)	-	-	-	-
416	Ring Lift	-	33632A	33632A	-
	(for cylinders without unloading)	-	-	-	-
416	Ring Lift	33632B	33632B	33632B	35318B
	(for cylinder adjacent to single cylinder unloading)	-	-	-	-
417	Retainer, Lift Ring	33633A	33633A	33633A	33633AB
418	Pin, Roll	1193E	1193E	1193E	1193E
419	Ring Liner Seat	33642A	33642A	33642A	35332A
419A	Seal Ring	-	-	-	2176E
420-422	Cylinder Plug Assembly	A32728A	-	-	-
420	Cylinder Plug	K32728A	-	-	-
421	O Ring	13264E	-	-	-