

CAPACITY REDUCTION, PISTON AND CONNECTING ROD

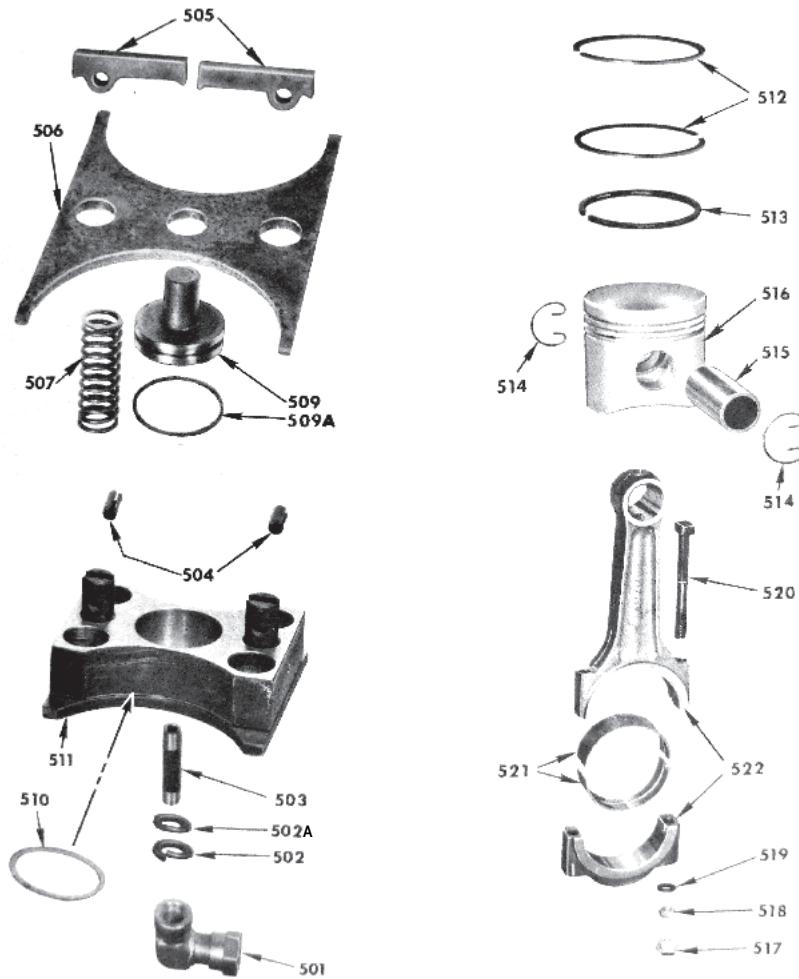

MODELS 320 & 350ES VMC

ITEM	DESCRIPTION	NUMBER OF CYLINDERS								PART NUMBER			
		3	3*	4	4*	5	6	6*	7		7*	8	8*
		Qty Per Compressor											
501	Elbow 90 Flareless	1	2	1	2	2	2	3	2	3	3	4	1892E
502	Washer Lock	1	2	1	2	2	2	3	2	3	3	4	13165E#
502A	"O" Ring	1	2	1	2	2	2	3	2	3	3	4	2176AX
503 thru 511	Capacity Reduction Mechanism	1	2	1	2	2	2	3	2	3	3	4	A33877A
503A	Nipple Pipe	1	2	1	2	2	2	3	2	3	3	4	13177
504	Roll Pin	2	4	2	4	4	4	6	4	6	6	8	1193K
505	Yoke Arm	2	4	2	4	4	4	6	4	6	6	8	33635A
506	Yoke	1	2	1	2	2	2	3	2	3	3	4	33637A
507	Yoke Spring	4	8	4	8	8	8	12	8	12	12	16	33686A
509 & 509A	Unloader Piston Ring Ass. Kit	1	2	1	2	2	2	3	2	3	3	4	KT1051
512 thru 522	Complete Connecting Rod and Piston Assembly	4	4	4	4	6	6	6	8	8	8	8	A32655B
512	Piston Ring, Compression	6	6	8	8	10	12	12	14	14	16	16	33662C
513	Rail, Oil Control Piston Ring	3	3	4	4	5	6	6	7	7	8	8	33662B
514 thru 516	Piston and Pin Assembly	3	3	4	4	5	6	6	7	7	8	8	A32639A
514	Ring, Piston Pin Retaining	6	6	8	8	10	12	12	14	14	16	16	33666 A
517 thru 522	Connecting Rod Assembly	3	3	4	4	5	6	6	7	7	8	8	Kit 1041
517	Nut, PAL	6	6	8	8	10	12	12	14	14	16	16	2028A
518	Nut, HEX 3/8"-24 UNF	6	6	8	8	10	12	12	14	14	16	16	2027A
519	Washer, Connecting Rod	6	6	8	8	10	12	12	14	14	16	16	33657A
520	Bolt, Connecting Rod 3/8" - 24 NF	6	6	8	8	10	12	12	14	14	16	16	33937A
521	Bearing Half, Connecting Rod Standard	3	3	4	4	5	6	6	7	7	8	8	Kit 512
521	Bearing Half, ConnectingRod (0.015 in. undersize)	3	3	4	4	5	6	6	7	7	8	8	Kit 513A
521	Bearing Half, ConnectingRod (0.030 in. undersize)	3	3	4	4	5	6	6	7	7	8	8	Kit 513
522	Connecting Rod with Cap	3	3	4	4	5	6	6	7	7	8	8	**
523	Oil Line Capacity Reduction Ass. (Cyl. 1 & 3 3, 3*, 4* Cyl.) (Cyl. 2 & 4 3*, 3, 4* Cyl.) (Cyl. 1 & 4 5, 6*, 6* Cyl.) (Cyl. 2 & 5 5, 6* Cyl.) (Cyl. 3 & 6 6*, 6* Cyl.) (Cyl. 1 & 5 7*, 8* Cyl.) (Cyl. 2 & 6 7, 7*, 8, 8* Cyl.) (Cyl. 3 & 7 7, 7*, 8, 8* Cyl.) (Cyl. 4 & 8 8, 8*, Cyl.)												33675A 33674A 33668A 33670A 33748A 33647A 33730A 33648A 33731A

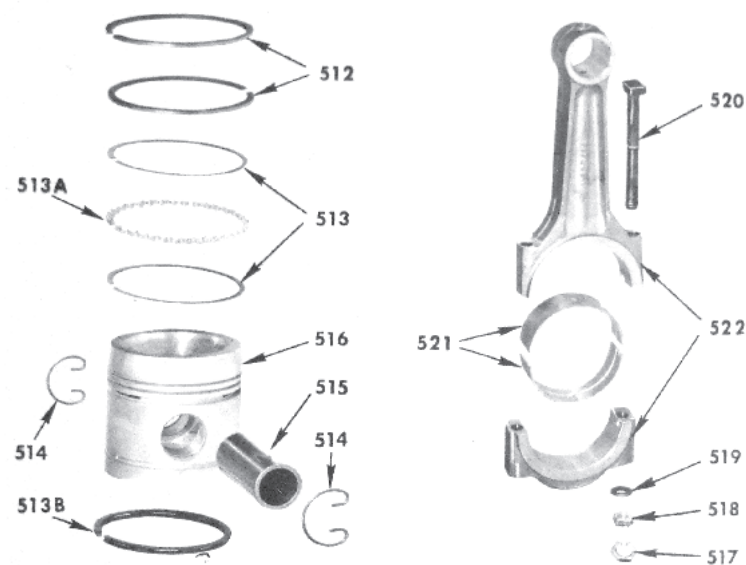

MODELS 330 & 340 VMC

ITEM	DESCRIPTION	NUMBER OF CYLINDERS						PART NUMBER
		3	4	5	6	7	8	
		Qty Per Compressor						
512 thru 522	Complete Connecting Rod and Piston Assembly	3	4	5	6	7	8	A34400A
512	Piston Ring, Compression	6	8	10	12	14	16	33662C
513	Rail, Oil Control Piston Ring	6	8	10	12	14	16	33662F
513-A	Spacer, Oil Control Piston Ring	3	4	5	6	7	8	33662E
513-B	Piston Ring, Saw Tooth Oil	3	4	5	6	7	8	33662D
514 thru 516	Piston and Pin Assembly	3	4	5	6	7	8	A32683A
514	Ring, Piston Pin Retaining	6	8	10	12	14	16	33666 A
517 thru 522	Connecting Rod Assembly	3	4	5	6	7	8	Kit 1041
517	Nut, PL	6	8	10	12	14	16	2028A
518	Nut, Plain Hex 3/8" - 24 UNF	6	8	10	12	14	16	2027A
519	Washer, Connecting Ro	6	8	10	12	14	16	33657A
520	Bolt, Connecting Rod 3/8" - 24 NF	6	8	10	12	14	16	33937A
521	Bearing Half, Connecting Rod	3	4	5	6	7	8	31957B
521	Bearing Half, ConnectingRod (0.030 in. undersize)	3	4	5	6	7	8	33579B*
522	Connecting Rod with Cap	3	4	5	6	7	8	**